

First Alert[®]

**Indoor/Outdoor
Analog Wireless Camera with Receiver
Model A-550**

USER'S MANUAL



©2010 Lehigh Consumer Products, LLC

All rights reserved. Distributed by Lehigh Consumer Products, LLC, Macungie, PA 18062.
Due to continuing product development, the product inside the packaging may look slightly different than the one on the package.

Lehigh Consumer Products, LLC is a subsidiary of Jarden Corporation (NYSE: JAH). To obtain warranty service, contact the Consumer Affairs Division at 1-800-323-9005, Monday through Friday, 7:30 a.m. - 5:00 p.m., Central Standard Time.

Made in China

M08-0256-002

First Alert

Table of Contents

Safety	1
Safety Precautions	1
FCC Compliance	1
Getting to Know Your A-550 System	2
Check Package Contents.....	2
Features.....	3
Setting Up Your A-550 System	4
Safety and Installation Tips	4
Device Operating Range.....	4
Installing the Camera	5
Setting the Camera's Channel	6
Connecting the Receiver to a DVR/VCR and TV	7
Viewing the Cameras on Your DVR/VCR/TV	8
Setting the Receiver's Channel	8
Night Vision.....	8
Troubleshooting	9
Technical Information	10
Receiver	10
Camera.....	10
Warranty.....	11
Product Limited Warranty.....	11
Warranty Exclusions	11
Obtaining Service	12

SAFETY PRECAUTIONS

- Do not drop, puncture, or disassemble the camera or receiver.
- Never tug on the power adapter. Use the plug to remove it from the wall.
- Do not expose the camera or receiver to high temperatures. Doing so may damage the camera or cause camera to malfunction temporarily.
- Use the device with care. Avoid pressing hard on the camera or receiver body.
- Do not crush or damage the power cables.

FCC COMPLIANCE

This device complies with Part 15 of the FCC Rules. Operation is subjected to the following two conditions: (1) this device may cause harmful interference, and (2) this device must accept any interference received, including interference that may cause undesired operation.

This equipment has been tested and found to comply with limits for a Class B digital device, pursuant to Part 15 of the FCC Rules. These limits are designed to provide reasonable protection against harmful interference in residential installations. This equipment generates, uses, and can radiate radio frequency energy and, if not installed and used in accordance with the instructions, may cause harmful interference to radio communications.

However, there is no guarantee that interference will not occur with a particular installation. If this equipment does cause interference to radio or television equipment reception, which can be determined by turning the equipment off and on, the user is encouraged to try to correct the interference by the following measures:

- Reorient or relocate the receiving antenna.
- Increase the separation between the equipment and the receiver.
- Connect the equipment into an outlet on a circuit different from that to which the received is connected.
- Consult the dealer or an experience radio/TV technician for help.

Notice: Changes or modifications to the product could void the user's authority to operate the product.

Getting to Know Your A-550 System

Congratulations on purchasing your First Alert Security Camera product. First Alert has been helping families and businesses stay safe for over 50 years. By having a First Alert Security Camera, you're taking the first step in protecting your home or business from damage or theft. We're watching, even when you're not.

CHECK PACKAGE CONTENTS

After unpacking the carton, check the contents for damage. Contact your supplier or dealer immediately if any part is missing or damaged.

- Analog Wireless Receiver (1)
- Analog Wireless Camera (1)
- Power Supply (2)
- Camera Stand (1)
- Mounting Kit (1)
- AV Cable (1)
- User's Manual (1)



FEATURES

- 380 TV lines for clear image resolution
- Infrared night vision
- Wireless 2.4 GHz transmission between camera and receiver up to 330 ft in open field conditions
- Record video direct to your VCR or DVR
- Sturdy weather resistant casing on camera
- Ideal entry-level solution for home or business
- Includes audio surveillance capability

Setting Up Your A-550 System

SAFETY AND INSTALLATION TIPS

- Do not attempt to open the camera. There are no user serviceable parts inside. Refer servicing to qualified service personnel.
- When installing the camera, follow manufacturer's advice when using power tools, steps, ladders, etc. and wear suitable protective equipment (e.g., safety goggles) when drilling holes. Before drilling holes through a ceiling, check for hidden electricity cables and water pipes. The use of a cable/pipe detector is advisable.
- When installing the camera on an external wall, pass the power cable through the wall as close as possible to the camera to reduce the chance of tampering with the cables. After drilling any hole through an external wall for cable, make sure the hole is sealed up around the cable using a sealant.

DEVICE OPERATING RANGE

The wireless camera is capable of transmitting up to 330 ft in open field conditions. However, when installed around your property, any solid objects (e.g., walls, ceiling, reinforced PVC doors, etc.) placed between the camera and receiver will reduce the range. For best transmission, avoid installations where there are very thick walls or major obstructions between the wireless camera and receiver. Avoid installing the camera or receiver next to a metal radiator, wireless router, or microwave oven.

If the camera is used with a digital video recorder (DVR) to record or view video on a TV, ensure the signal reception is the best possible reception (i.e., no interference lines on the TV). If necessary, reduce the distance between the camera and receiver. You may find that if the wireless camera is installed outside, the maximum operating range without interference may be no less than 50 ft.

INSTALLING THE CAMERA

- 1 Select the position for the camera and secure the camera bracket.
Screws and anchors are supplied. Use an appropriate screw type for the mounting surface
- 2 Loosen the T-bolt.



- 3 Adjust camera to the proper view angle and tighten the T-bolt.
Make sure the lens is upright relative to your subject (antenna should be relatively upright).
- 4 Connect the camera to power using the supplied power cable and adapter.
The power adapter is not weather resistant and needs to be sheltered from moisture, rain, and sunlight.

SETTING THE CAMERA'S CHANNEL

The A-550 wireless camera has four selectable channels to avoid any interference from any other wireless devices. Follow the steps below to set or change the frequency channel of the camera. If you are adding another camera to an existing system, make sure its channel is different from the channel of the existing camera.

- 1 Pull open the rubber flap on the camera's power cable.
- 2 Locate the two dip switches under the rubber flap.



- 3 Use the dip switch tool to flip the switches to change the camera's transmitting channel.



- 4 Set the camera channel using the switch configuration below. Do not set more than one camera on the same channel or interference will appear on the screen.

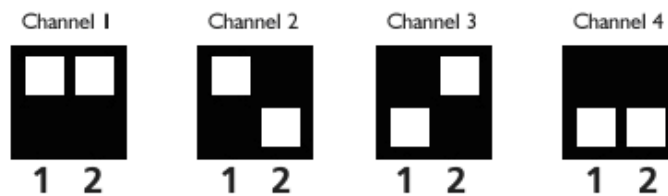

Note: It is possible to link four wireless cameras to a receiver. However, you may need to adjust the orientation of the antenna on the receiver for the channel being viewed.

CONNECTING THE RECEIVER TO A DVR/VCR AND TV

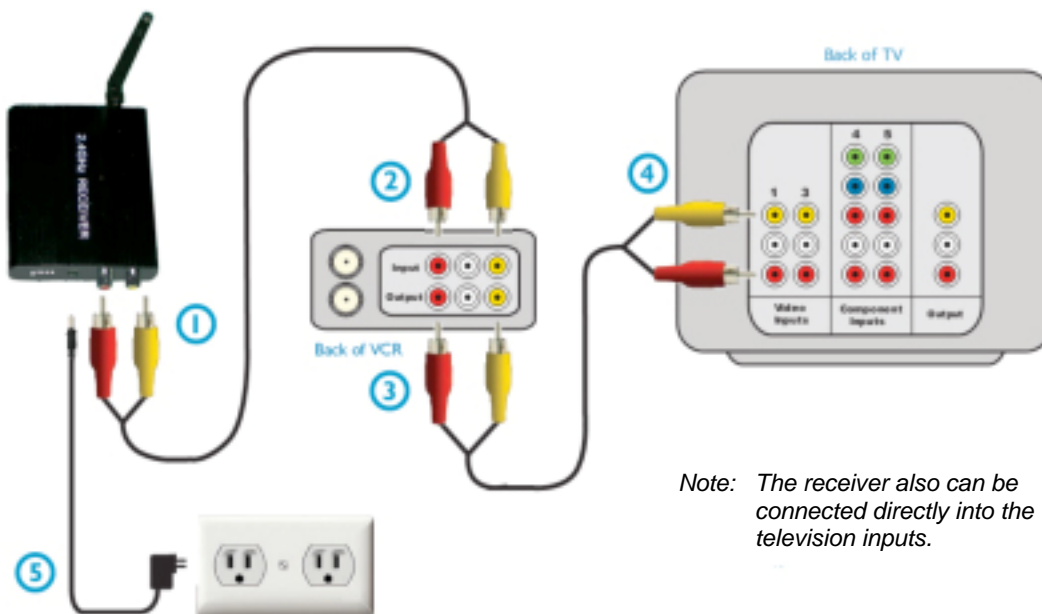

Note: The receiver also can be connected directly into the television inputs.

- 1 Connect one end of the AV cable (supplied) to the Receiver.
- 2 Connect other end of AV cable to INPUT on DVR/VCR.
- 3 Connect one end of another AV cable (not supplied) to the DVR/VCR OUTPUT.
- 4 Connect other end of the AV cable to INPUT on TV.
- 5 Connect the power cable (supplied) to the Receiver.

VIEWING THE CAMERAS ON YOUR DVR/VCR/TV

- 1 Power on the Receiver, DVR/VCR, and TV.
- 2 Tune your TV to the correct INPUT (e.g., INPUT1).
- 3 Using your DVR/VCR's remote control tune your DVR/VCR to the INPUT.
- 4 You should now see your camera on the TV screen. Follow your manufacturer's instructions to record to your DVR/VCR.

Note: You can watch the video directly on your TV without using a DVR/VCR.

Setting Up Your A-550 System

Model A-550 User's Manual

SETTING THE RECEIVER'S CHANNEL

The wireless receiver is capable of receiving up to four separate channels. The front of the wireless receiver has four LEDs corresponding to the four channels. When lit, the LED indicates which channel is currently being displayed.

The wireless receiver allows you to switch manually between active channels by pushing the SET button when all channel switches are on. Each time the SET button is pushed, the receiver changes to the next channel (CH1 to CH2 to CH3 to CH4, and back to CH1).



NIGHT VISION

The camera has built-in infrared LEDs to allow you to view up to a distance of 16 ft at night for 24-hour surveillance. The LEDs automatically activate at night and the picture viewed turns to a black and white image.

TROUBLESHOOTING

Problem	Solution
No picture.	Make sure the cameras and receiver are plugged in. Make sure the TV/ VCR/ DVR is tuned to the correct input channel.
A white image appears at night.	The camera's infrared LEDs shine invisible light that reflects off surfaces such as glass causing white light. Place the camera on the other side of windows or place the lens flush against the surface to improve night vision. Relocate the camera to a well-lit area.
I keep getting interference.	Wireless cameras operate on the 2.4 GHz frequency like many devices such as wireless routers, cordless phones, and microwaves. If possible, keep the cameras away from these devices.

Technical Information

RECEIVER

Transmission Channels	4
Transmission Range	330 ft ♦
Power Supply	DC 12V

CAMERA

Image Device	¼" CMOS
Video System	NTSC
Resolution	380 TV lines
Min. Illumination	0 LUX (IR ON)
Lens	6 mm
LEDs	11
Effective Pixels	NTSC: 512 (H) x 492 (V)
Signal/Noise Ratio	> 46 dB
Transmission Range	330 ft ♦
Video Output	1 Vp-p / 75 Ohms
Operating Temperature	14°F – 113°F
Power Supply	DC 12V
Indoor/Outdoor	Both
Dimensions	
Camera and Stand	5.1" x 2.0" x 2.0"
Receiver	4.1" x 3.0" x 1.0"
Viewing Angle	35 degrees
Audio Surveillance	Yes
Audio Range	10 ft
Night Vision Distance	16 ft

♦ Transmission Range may be shorter than 330 ft due to building structure or environment interference.

PRODUCT LIMITED WARRANTY

BRK Brands, Inc., (“BRK”) the maker of First Alert® brand products warrants that for a period of one year from the date of purchase (the “Warranty Period”), this product will be free from defects in material and workmanship. BRK, at its sole option, will repair or replace this product or any component of the product found to be defective during the Warranty Period. Replacement or repair will be made with a new or remanufactured product or component. If the product is no longer available, replacement may be made with a similar product of equal or greater value. This is your exclusive warranty.

This warranty is valid for the original retail purchaser only from the date of initial retail purchase and is not transferable. In order to obtain warranty service, you must keep the original sales receipt and proof of purchase in the form of the UPC code from the package. BRK dealers, service centers, or retail stores selling BRK products do not have the right to alter, modify or any way change the terms and conditions of this warranty.

WARRANTY EXCLUSIONS

Parts and Labor: 1 year limited (warranted parts do not include bulbs, LEDs, and batteries)

This warranty does not apply to bulbs, LEDs, and batteries supplied with or forming part of the product.

This warranty is invalidated if non- BRK accessories are or have been used in or in connection with the product or in any modification or repair is made to the product.

This warranty does not apply to defects or damages arising by use of the product in other than normal (including normal atmospheric, moisture and humidity) conditions or by installation or use of the product other than in strict accordance with the instructions contained in the product owner’s manual.

This warranty does not apply to defects in or damages to the product caused by (i) negligent use of the product, (ii) misuse, abuse, neglect, alteration, repair or improper installation of the product, (iii) electrical short circuits or transients, (iv) usage not in accordance with product installation, (v) use of replacement parts not supplied by BRK, (vi) improper product maintenance, or (vii) accident, fire, flood or other Acts of God.

This warranty does not cover the performance or functionality of any computer software included in the package with the product. BRK makes no warranty that the software provided with the product will function without interruption or otherwise be free of anomalies, errors, or “Bugs.” This warranty does not cover any costs relating to removal or replacement of any product or software installed on your computer.

BRK reserves the right to make changes in design or to make additions to or improvements in its products without incurring any obligations to modify any product which has already been manufactured. BRK will make every effort to provide updates and fixes to its software via its website. This warranty does not cover any alteration or damage to any

Technical Information

Model A-550 User's Manual

other software that may be or may become resident on the users system as a result of installing the software provided. This warranty is in lieu of other warranties, expressed or implied, and BRK neither assumes nor authorizes any person to assume for it any other obligation or liability in connection with the sale or service of the product. In no event shall BRK be liable for any special or consequential damages arising from the use of the product or arising from the malfunctioning or non-functioning of the product, or for any delay in the performance of this warranty due to any cause beyond its control.

BRK does not make any claims or warranties of any kind whatsoever regarding the product's potential, ability, or effectiveness to prevent, minimize, or in any way affect personal or property damage or injury. BRK is not responsible for any personal damage, loss, or theft related to the product or to its use for any harm, whether physical or mental related thereto. Any and all claims or statements, whether written or verbal, by salespeople, retailers, dealers, or distributors to the contrary are not authorized by BRK, and do not affect this provision of this warranty.

BRK's responsibility under this, or any other warranty, implied or expressed, is limited to repair, replacement or refund, as set forth above. These remedies are the sole and exclusive remedies for any breach of warranty. BRK is not responsible for direct, special, incidental, or consequential damages resulting from any breach of warranty or under any other legal theory including but not limited to, loss profits, downtime, goodwill, damage to or replacement of equipment and property and any costs of recovering, reprogramming or reproducing any program or data stored in or used with a system containing the product accompanying software.

BRK does not warrant the software will operate with any other software except that which is indicated. BRK cannot be responsible for characteristics of their party hardware or software which may effect the operation of the software included.

Except to the extent prohibited by applicable law, any implied warranty of merchantability or fitness for a particular purpose is limited in duration to the duration of the above Warranty Period. Some states, provinces, or jurisdictions do not allow the exclusion or limitation of incidental or consequential damages or limitations on how long an implied warranty lasts, so the above limitations or exclusion may not apply to you. This warranty gives you specific legal rights, and you may also have other rights that vary from state to state, or province to province, or jurisdiction to jurisdiction.

OBTAINING SERVICE

If service is required, do not return the product to your retailer. In order to obtain warranty service, contact the Consumer Affairs Division at 1-800-323-9005, 7:30 a.m. – 5:00 p.m. Central Standard Time, Monday through Friday. To assist us in serving you, please have the model number and date of purchase available when calling.

After contacting the Consumer Affairs Division and it is determined that the product should be returned for Warranty Service, please mail the product to: Lehigh, 2834 Schoeneck Rd, Macungie, PA 18062-9679.