

AS3020 – AS3039 series

Upright vacuum cleaner, household type

QUICK START GUIDE

THANK YOU FOR PURCHASING YOUR NEW EUREKA VACUUM!

Please take a few moments to read this Quick Start Guide. It is designed to help you assemble your vacuum easily.

To view an assembly video, go to Eureka.com/videos or scan QR code. If you have questions about your new vacuum, please contact our customer service helpline at 1-800-282-2886. We're here to help!



Helpline hours:

8 a.m. to 7:30 p.m. (CST), Monday - Friday
10 a.m. to 6:30 p.m. (CST), Saturday - Sunday

¡GRACIAS POR LA COMPRA DE SU NUEVA ASPIRADORA EUREKA!

Por favor, dese unos momentos para leer esta Guía de Inicio Rápido. Hasido diseñada para ayudarte a ensamblar su aspiradora fácilmente. Para ver un video sobre cómo armar, visite Eureka.com/videos o escanee el código QR. Si tiene alguna pregunta sobre su nueva aspiradora, por favor contacte a nuestra línea de ayuda de atención al cliente llamando al 1-800-282-2886. ¡Estamos aquí para ayudarle!

Hora helpline:

8 a.m. a 7:30 p.m. (CST), de lunes a viernes
10 a.m. a 6:30 p.m. (CST), sábado y domingo

MERCI D'AVOIR ACHETÉ VOTRE NOUVEL ASPIRATEUR EUREKA!

Veillez prendre quelques instants pour lire ce Guide de démarrage rapide. Il est conçu pour vous aider à assembler rapidement votre aspirateur. Pour visualiser la vidéo d'assemblage, rendez-vous à l'adresse Eureka.com/videos ou balayez le code QR. Si vous avez des questions au sujet de votre nouvel aspirateur, veuillez contacter notre Ligne d'aide du Service à la clientèle au 1-800-282-2886. Nous sommes là pour vous aider!

Heures helpline :

8 h à 19 h 30 (CST), lundi au vendredi
10 h à 18 h 30 (CST), samedi et dimanche

www.eureka.com

© 2014 Electrolux Home Care Products, Inc. Printed in China P188337



eureka

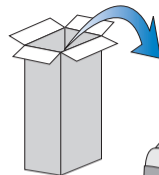

AS3030 Series

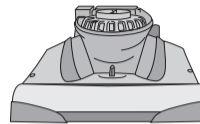

AS3020 Series

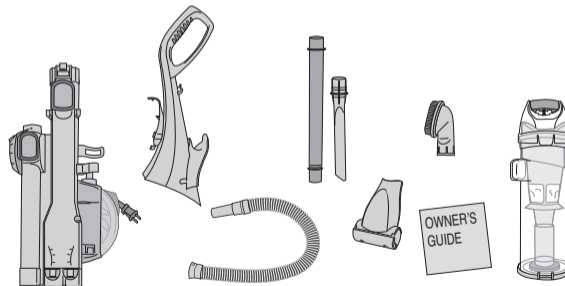

OWNER'S GUIDE

Eureka Customer Service HELPLINE 1-800-282-2886

www.eureka.com

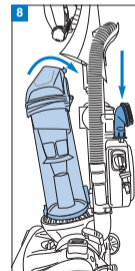
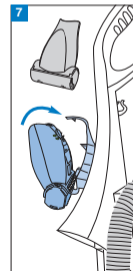
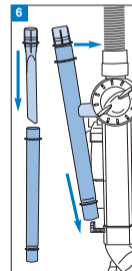
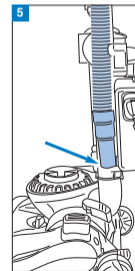
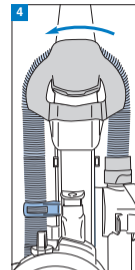
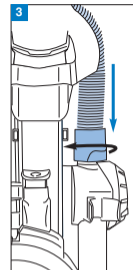
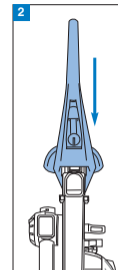
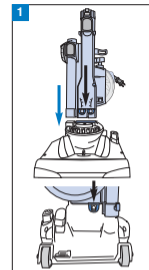

Eureka Customer Service HELPLINE 1-800-282-2886

www.eureka.com

Comment utiliser votre l'aspirateur

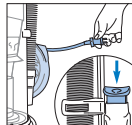

Sortez tout le cordon. Enfoncez le bouton pour rembobiner le cordon.

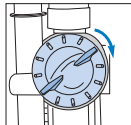

Pour passer l'aspirateur sur les planchers, tournez le bouton de voie d'air à « FLOORS » (planchers).

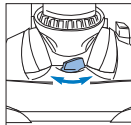

Tournez le bouton pour ajuster la hauteur pour les planchers nus et à bas ou haut pour les fibres de tapis.

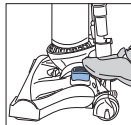

Certains modèles : Montez sur la pédale pour mettre en marche le cylindre brosseur pour le tapis ou pour l'arrêter pour les planchers nus.

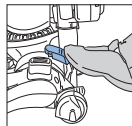

Montez sur l'interrupteur pour mettre l'aspirateur en marche, remontez pour éteindre.

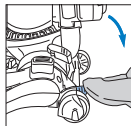

Montez sur le dégagement de poignée pour abaisser la poignée en place.

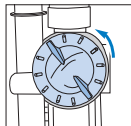

Pour utiliser les accessoires, tournez le bouton de voie d'air à la position « TOOLS » (accessoires).

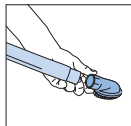

Installez l'accessoire à l'extrémité du boyau ou du tube.

⚠ Videz toujours le collecteur de poussière après chaque utilisation. Nettoyez les filtres fréquemment.

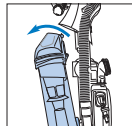

Videz toujours le collecteur dépollués après chaque utilisation.



Enfoncez le levier pour dégager le couvercle inférieur. Les débris se videront.

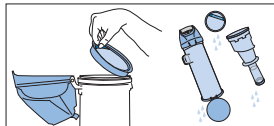

Tirez le verrou pour soulever le couvercle. Soulevez le filtre de mousse et l'écran du filtre; secouez pour enlever la poussière. Rincez le filtre de mousse, l'écran du filtre et le collecteur de poussière. Asséchez complètement. Réinstallez le filtre de mousse, l'écran du filtre et le collecteur de poussière.

Cómo usar su aspiradora

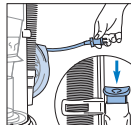

Saque el cable completamente. Aprieta el botón para rembobinar el cable.

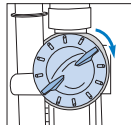

Para limpiar pisos, gire la perilla de la trayectoria del aire a la posición de 'FLOORS' (pisos).

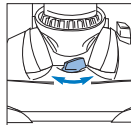

Haga girar la perilla para ajustar la altura para pisos desnudos y para alfombras de pelo corto (Low) a largo (High).

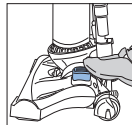

Algunos modelos: Pise el pedal para encender el cepillo de rodillo para alfombras, o para apagarlo para pisos desnudos.

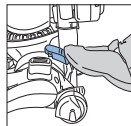

Para encender, pise el pedal interruptor; para apagar, vuelva a pisarlo.

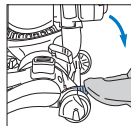

Pise el pedal para liberar la agarradera y colocarla en posición.

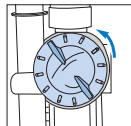

Para usar los accesorios, gire el selector de la trayectoria del aire a la posición "TOOLS" (herramientas).

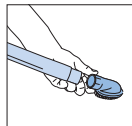

Coloque la herramienta en el extremo de la manguera o de la varilla.

⚠ Vacíe el recipiente para el polvo después de cada uso. Limpie los filtros con frecuencia.

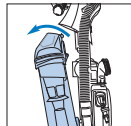

Vacíe el recipiente para el polvo después de cada uso.



Presione la palanca para bajar la tapa. Los desechos se vaciarán.

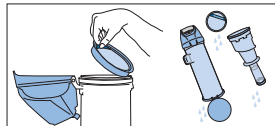

Jale la aldamá para levantar la tapa. Saque el filtro de espuma y la pantalla del filtro; sacuda el polvo. Enjuague el filtro de espuma, la pantalla y el recipiente para el polvo. Saque todo muy bien. Vuelva a instalar la pantalla, el filtro de espuma y el recipiente para el polvo.

How to use your vacuum cleaner

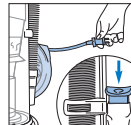

Pull out cord to desired length. Press button to rewind cord.

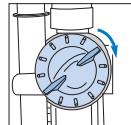

To vacuum floors, turn air path knob to 'FLOORS.'

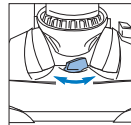

Turn knob to adjust height for bare floor and Low to High pile carpet.

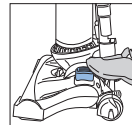

Some models: Step on pedal to turn brush roll on for carpet or off for bare floors.

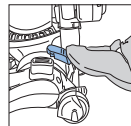

Step on power switch to turn on; step on again to turn off.

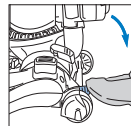

Step on handle release to lower handle into position.

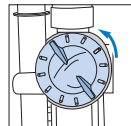

To use tools, turn air path knob to 'TOOLS.'

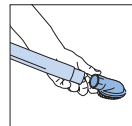

Attach tool to end of hose or wand.

⚠ Empty dust cup after every use. Clean filters frequently.

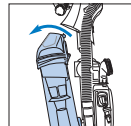

Lift latch and pull out dust cup.



To empty debris, press lever to release bottom lid.

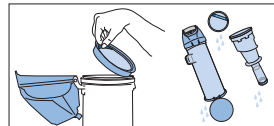

Pull latch to lift up cover. Lift out foam filter and filter screen; shake of dust. Rinse foam filter, screen and dust cup. Dry all thoroughly. Reinstall screen, foam filter and dust cup.