



# TOP-FILL - ULTRASONIC COOL MIST HUMIDIFIER

## USER MANUAL

FOR MODEL:  
PAU14



Before using your ultrasonic humidifier, please read this manual carefully and keep it for future reference, along with your receipt.

## **CONSUMER PRODUCT INFORMATION**

---

For your own records, please attach a copy of your sales receipt to this manual.  
Also, write the store name/location and date purchased below:

Store Name: \_\_\_\_\_

Location: \_\_\_\_\_

Date Purchased: \_\_\_\_\_

# CONTENTS

---

Safety Guidelines .....	2-3
Technical Data.....	3
Features.....	3
Parts Diagram.....	4
Humidifier Placement .....	5
Operating Instructions.....	6-7
Weekly Maintenance Cleaning & Care .....	8-9
Storage Instructions .....	9
Warranty .....	10
Troubleshooting .....	11

# SAFETY GUIDELINES

---

When using electrical appliances, basic safety precautions should always be followed. Failure to follow these safety precautions may result in personal injury, property damage, fire or shock.

1. Always have water in water tank when operating unit.
2. Use only filtered or clean tap water. Using tap water with a high mineral content (hard water) will result in a white dust and the need for more frequent cleanings. Hard water can be harmful to unit and may eventually cease its operation.
3. Position the unit within the room so the air output from the mist control output nozzle is aimed away from children, walls and furniture (min. 36 in. clearance).
4. When removing the tank, firmly hold tank with both hands.
5. DO NOT use if tank is cracked.
6. DO NOT place the appliance near heating devices such as a stove. Keep unit out of direct sunlight. Keep the cord away from heated surfaces and areas where it can be stepped on or tripped over.
7. Use only 110-120V AC outlet. Be sure unit is plugged in firmly and completely. As with any electrical device, plug and unplug unit with dry hands only.
8. Turn the humidifier off and unplug the unit when not in use, when moving or when cleaning.
9. To avoid the risk of fire, shock or personal injury, do not use an extension cord.  
Warning: Never operate unit with a damaged cord or plug.
10. DO NOT place on floor or carpet. Always place unit on a flat, level, waterproof surface at least 24 inches off floor AWAY from direct sunlight, computers or other sensitive electronic equipment.
11. DO NOT place the humidifier on wood furniture or other surfaces that can be damaged by water.
12. DO NOT place on towel or soft surface. This will block the air vent and cause overheating.
13. DO NOT add medication or cleaning products of any type into the mist control nozzle, base or water tank. DO NOT add essential oils or additives to the water in the tank. Essential oils should only be placed in the essential oil pod. Follow essential oil pod instructions in this manual. (See "Weekly Maintenance Cleaning & Care" section of this manual for proper instructions on cleaning the unit.) DO NOT cover, block or place anything over any opening. NEVER drop or insert any object into any openings.
14. The unit should not be left unattended in closed rooms as air could become saturated and leave condensation on walls or furniture. Always leave room door partially open.
15. DANGER: NEVER immerse the humidifier motor unit (base) in water or other liquids as electrical shock may occur.
16. DO NOT use outdoors.
17. Turn humidifier OFF if the relative humidity exceeds 60% or if you notice condensation on inside of windows. For proper humidity reading, use a hygrometer which is available in many retail stores.
18. The nebulizer (ultrasonic transducer) is highly sensitive. Keep this important part clean and treat it gently. Only clean per instructions (pg 8).  
WARNING:
  - Do not touch the nebulizer while the unit is operating, as possible burns could result.
  - Do not touch the nebulizer with fingers. Any residue on the metal will reduce mist output.
19. The unit contains no consumer serviceable parts. To reduce the risk of electrical shock, do not attempt to open the base of the humidifier.

## SAFETY GUIDELINES (CONTINUED)

**DANGER!** To reduce the risk of electrical shock, this product has a polarized plug (one blade is wider than the other). As a safety feature this plug will fit into the outlet only one way. If the plug does not fit fully into the outlet, reverse the plug. If it still does not fit, contact a qualified electrician. DO NOT attempt to bypass this safety feature. Improper use of electric cords and plugs can cause a fire or electric shock hazard. NEVER pull on the cord to remove the plug from the outlet. Grip plug and pull from outlet. Check the power cord and plug for damage. A damaged cord or plug must be repaired before using the humidifier.

## TECHNICAL DATA

Model: PAU14

Voltage: 110-120V~/60Hz

Watts: 25W

Max. Run Time: 38 hours

Water Tank Capacity: 1.4 gallons

### FOR HOUSEHOLD USE ONLY

All data was tested by the factory and is for reference only.

This product is designed for home use only.

## FEATURES



**PERFECT AIRE  
MICRO MIST®**



**REFILL  
INDICATOR**



**ACTIVE CARBON  
FILTER (WASHABLE)**



**WHISPER QUIET  
OPERATION**



**AUTO  
SHUT-OFF**



**360° ADJUSTABLE  
OUTPUT DIRECTION**



**ADJUSTABLE  
OUTPUT LEVELS**



**EASY  
TO FILL**



**ESSENTIAL OIL POD**

### ULTRASONIC TECHNOLOGY

Ultrasonic technology is widely used in various domains. Water is atomized by ultrasonic sound waves and propelled through the air by a small fan. These ultrasonic pulses are silent and produce visible mist that quickly disperses to increase the level of humidity in the immediate area. The unit features an easy to clean ultrasonic transducer (nebulizer) for increased longevity.

### AUTO SHUT OFF PROTECTION / WATERLESS INDICATOR

When the water tank is empty, the motor will shut off automatically and the Power Indicator Light will turn red.

### PERFECT AIRE MICRO MIST®

Perfect Aire Micro Mist® water particles are smaller than water particles produced by regular ultrasonic humidifiers. Benefits of Perfect Aire Micro Mist® technology include up to 40% greater output, water vapor particles 70-80% smaller for quicker air dispersion, 25% greater room coverage, and less condensation on and around unit.

### OVERLOAD PROTECTION

The unit will automatically shut off if a circuit is overloaded.

# PARTS DIAGRAM

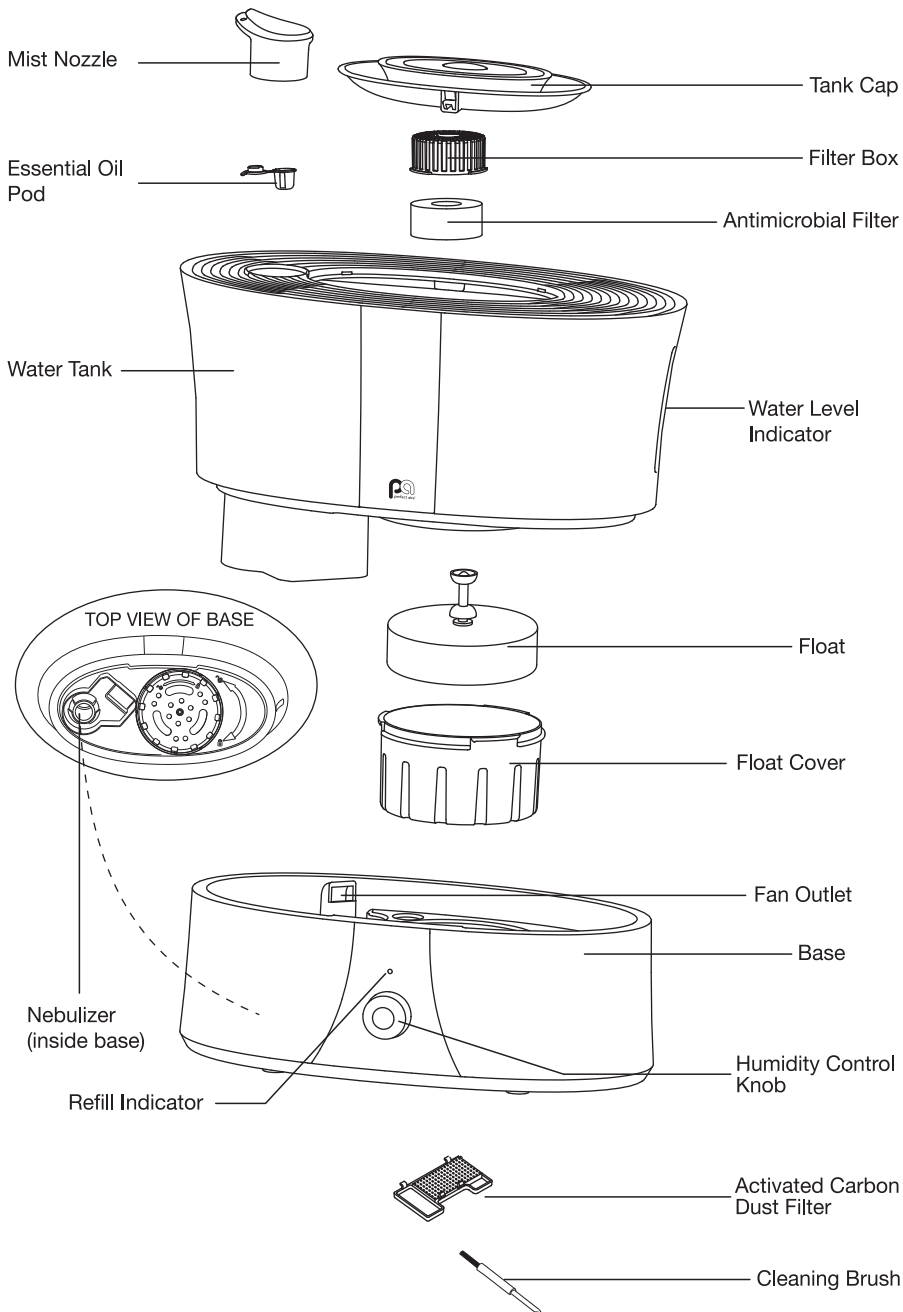

# HUMIDIFIER PLACEMENT

## SAFETY NOTES:

- Make sure the power cord plug and socket are well connected to prevent overheating.
- Clean the unit after extended periods of non-use as the water tank and base can easily breed bacteria.
- When moving the unit, firmly hold the base with both hands to avoid water from overflowing from the base.
- The unit should be placed on a flat, stable surface, but not on a wood surface.
- DO NOT place the unit on a towel or soft surface. Doing so will block air flow and cause overheating and damage to the unit.
- The unit should be kept 6 ft from TVs, speakers, and any other appliances.
- Mist outlet should have at least 8 inches of clearance in all directions.

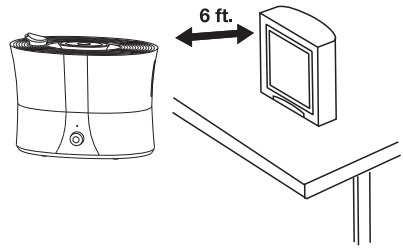
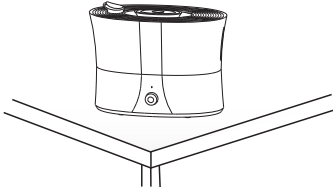

- DO NOT use the unit near gas appliances, heating devices and fire.
- When using a natural gas stove, using this unit may change the color of the flame due to the minerals in the water.
- DO NOT place the unit in direct sunlight and/or near a fireplace.

- Do not place any items on top of the unit.
- Do not place the unit in a place where it can easily touch curtains.

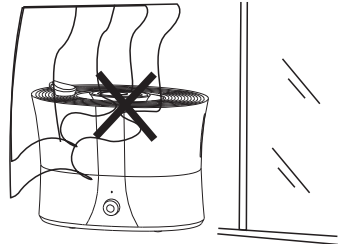
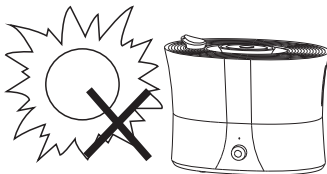

- Do not pour water in through the mist outlet.



# OPERATING INSTRUCTIONS

NOTE: When unpacking the unit, make sure to locate the mist nozzle and cleaning brush before discarding all packaging material.

1. Press the button located in the center of the tank cap to remove.

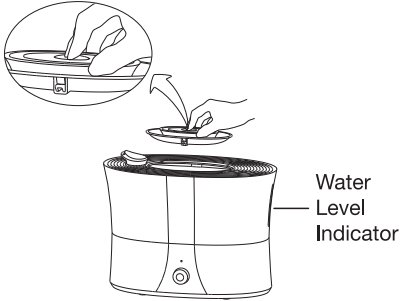

2. Fill a pitcher or container with filtered or clean tap water to fill the tank, no more than 1.4 gallons. Pay attention to the water level indicator on the side of the tank.

NOTE: If you will be removing the tank to refill, hold the tank above the base for a few seconds to let the water drip. Have a hand towel or washcloth available in case of dripping water.

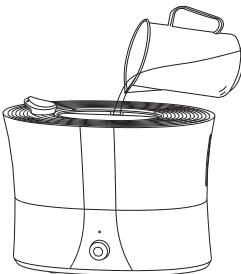

3. Replace the tank cap.

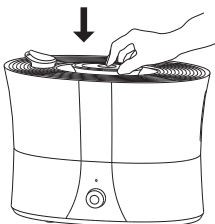

4. Plug the humidifier directly into the wall outlet. DO NOT handle the plug with wet hands.

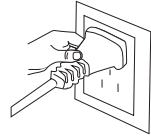

## DANGER!

Improper use of electric cords and plugs can cause a fire or electric shock hazard. NEVER pull on the cord to remove the plug from the outlet. Grip plug and pull from outlet. Check the power cord and plug for damage. A damaged cord or plug must be repaired before using the humidifier.

5. Turn the humidity control knob clockwise to turn the unit On. The indicator light will be Green when full of water and Red when empty. Adjust the mist output by turning the knob clockwise. The further the knob is turned to the right, the more mist will be produced. See images below for reference.



Off



Minimum Mist



Maximum Mist



NOTE: When refilling the water tank or moving the humidifier, please turn the unit off and unplug it.



# OPERATING INSTRUCTIONS (CONTINUED)

## ADDING FRAGRANCE

The mist outlet of the product has a built-in essential oil pod. (Essential oils not included.) Put aromatherapy/essential oils into the fragrance pod based on your personal preference. The scent emits with the mist, filling the area with fragrance, which may relieve physical and mental stress.

1. Remove the mist outlet to access the essential oil pod.

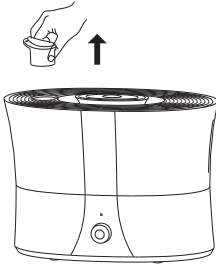

4. If more scent is desired, open the cap on the pod.

If less scent is desired, keep the cap on the pod closed.

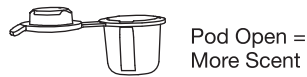

2. Open the essential oil pod. Place a few drops of the oil into it, and close the lid of the pod.

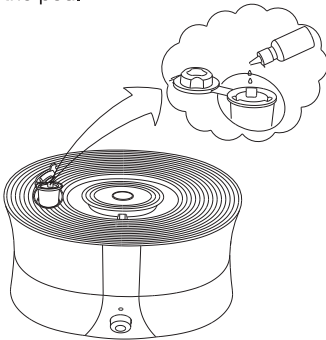

NOTE:  
Aromatherapy/essential oils are not included with the unit.

3. Place the pod back into the mist outlet.

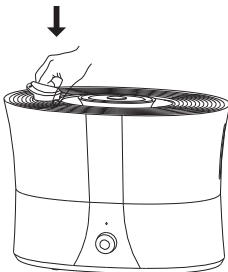

# WEEKLY MAINTENANCE CLEANING & CARE

For optimum performance, clean your humidifier weekly according to the following instructions.

- IMPORTANT:**
- Always unplug the power cord before cleaning.
  - NEVER use any cleaning products/solutions which are abrasive, corrosive or flammable, as these can be harmful to the unit and void warranty if used.

## WATER TANK CLEANING INSTRUCTIONS

1. Remove the water tank cover.

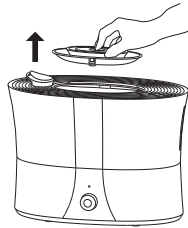

2. Lift the water tank and let the water drip into the base before moving. Have a towel handy.

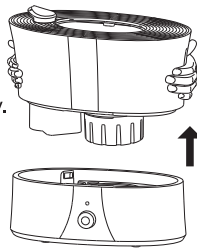

3. Empty the water tank into the sink. Turn the filter cover to the left (counter-clockwise) to where it stops and lift up to remove.

**NOTE: DO NOT** clean tank in the dishwasher.

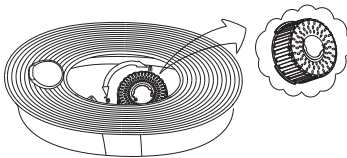

4. Remove the antibacterial filter from the cap, clean the filter, and then reinstall filter into cap. Set aside.

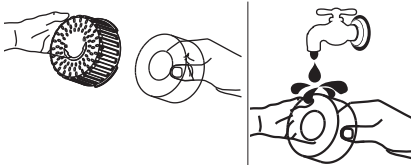

5. Turn the floating cap left (counter-clockwise) until it stops. Lift the cap to remove. Clean the floating cap with a soft brush (provided) and rinse the float with water.

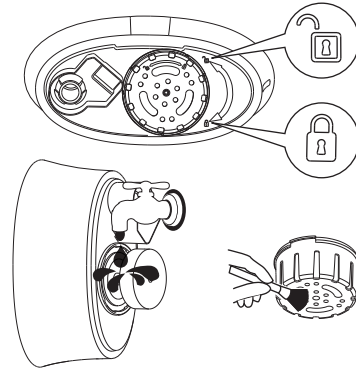

6. Fill the tank with a solution of bleach and water. (Use 1 teaspoon of household bleach in one gallon of water.)
7. Let solution stand for 20 minutes, shaking every few minutes.
8. Rinse with warm water until the bleach smell is gone.

Regularly clean the humidifier inlet (activated dust carbon filter) to prevent dust accumulation. After the humidifier is used for a period of time, the air inlet at the bottom can become blocked. Use a clean, dry brush or a vacuum cleaner to clean the air inlet before use.

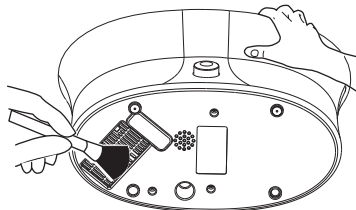

Continued on Next Page >

# WEEKLY MAINTENANCE CLEANING & CARE (CONT.)

9. Put the filter cap back into the tank and turn right (clockwise) until it stops.

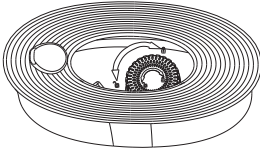

10. Reinstall the float cap by rotating it to the right until it stops. Then place the water tank back onto the base.

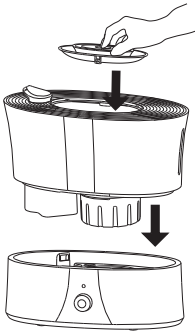

## BASE CLEANING INSTRUCTIONS

1. Fill the base with one 8-oz cup of undiluted white vinegar.
2. Let solution stand for 20 minutes.
3. With the vinegar in the base, clean all interior surfaces with a soft cloth or brush to help remove scales. Do not touch the nebulizer with fingers. Any residue on the nebulizer will reduce mist output.
4. Carefully rinse with clean, warm water and gently wipe clean.

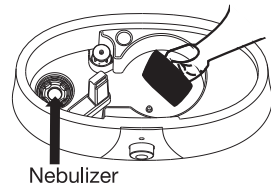
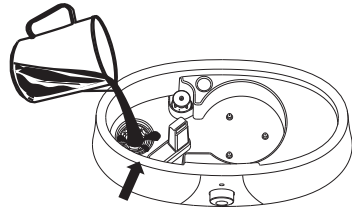

## STORAGE INSTRUCTIONS

1. Clean unit thoroughly according to instructions and allow to dry completely before storing.
2. Store unit in an upright position away from sunlight. Do not store in temperatures below 41°F.

# ONE YEAR LIMITED WARRANTY

---

**PERFECT AIRE®** warrants that during the first year from the original date of purchase, this product will be free from defects in material and workmanship. Perfect Aire, at its discretion, will repair or replace this product or any component of this product found to be defective during the warranty period. This is a one-time replacement warranty. If the product is no longer available, Perfect Aire will replace the unit with a similar model of equal or greater value.

**This warranty is not transferable.**

**Proof of purchase is REQUIRED in order to obtain warranty assistance.**

**This warranty does NOT cover:**

- Damages caused by improper installation or improper cleaning.
- Negligent use or misuse of the product.
- Damages as the result of not using product in accordance with provided instructions.
- Damage to product, walls paintings/portraits, furniture, floor, etc. as the result of high mineral content in water.
- Damage to product, walls, paintings/portraits, any furniture (wood), floors, etc. as a result of improper installation and/or cleaning.
- Use of improper voltage or current.
- Additional or extended warranties offered by retailers.
- Disassembly or repair by anyone other than an authorized Perfect Aire service center provider.
- Products used in a commercial setting.
- Floor display 'as-is' models.
- Damage caused by acts of nature such as hurricane, tornado, fire, etc.
- Incidental or consequential damages caused by breach of any expressed, implied or statutory warranty or condition with exception to the extent prohibited by law.
- Any performance issues that fall outside of the 1 year warranty.

Note: Some states do not allow the exclusion or limitation of incidental or consequential damages. This limitation or exclusion may not apply to you.

**DO NOT RETURN THIS PRODUCT TO THE STORE.**

**If you have any questions about this product or its warranty, please call consumer services at toll-free 844-4PA-AIRE (844-472-2473).**

# TROUBLESHOOTING

Please check the following troubleshooting tips before calling for assistance.

PROBLEM	REASON	SOLUTION
Power light is off	Unit not plugged in.	Plug in unit and turn on the power / output adjustment knob.
	Wall outlet has no power.	Check the circuit and fuse; try another socket.
	Check power cord.	If damaged, call Consumer Services at 844-4PA-AIRE (844-472-2473)
Unit / Mist has peculiar smell	New unit.	Air unit out in cool place for 12 hours without the tank on the unit.
	The water is dirty or stale.	Thoroughly clean unit and place fresh water in tank.
Excessive noise	Vibration between the humidifier and surface.	Place the unit on a stable, waterproof surface.
	Low water level in water tank.	Fill the water tank.
White dust	Water contains high mineral content.	Switch to distilled or filtered water; clean nebulizer according to instructions.
Damp table or floor	Unit too far from end of table or too close to floor.	Move unit closer to edge of table so mist has more time to disperse. Do not place unit on floor.
	Base overflowed.	Tank cap not securely attached or needs replacement.
No mist / Little mist / Mist stuck	Base overfilled.	Empty base and restart.
	No water in the water tank.	Add water to the water tank.
	The power / output adjustment knob is not turned on.	Rotate the power / output adjustment knob clockwise to power the unit on.
	The humidifier is not on a flat surface.	Put the humidifier on a flat surface.
	There is scaling on the nebulizer / transducer.	Clean the nebulizer / transducer according to instructions.
	Tank was cleaned with wrong type of cleaner.	Use fresh water to clean the water tank completely and then let tank dry completely.
	The water level is too low.	Add water to the water tank.
	The water is dirty or stale.	Thoroughly clean unit and place fresh water in tank.
The nebulizer / transducer or fan does not work.	Call Perfect Aire Consumer Services: 844-4PA-AIRE (844-472-2473)	
Condensation on windows or machine	The room is too small or too humid.	Turn down the mist volume or turn the unit off completely.
Scaling on nebulizer / transducer	Water is too hard.	Use distilled or filtered water.

After reviewing the above troubleshooting tips, should you have any questions or concerns, please call Consumer Services at 844-4PA-AIRE (844-472-2473).





**Distributed by:**



Perfect Aire, LLC  
5401 Dansher Rd.  
Countryside, IL 60525

**844-4PA-AIRE | 844-472-2473**  
**[www.perfectaire.us](http://www.perfectaire.us)**

PA/User\_PAU14/07052019

Specification and performance data is subject to change without notice.

Printed in China