

Welcome to the world of KitchenAid®

We're committed to helping you create a lifetime of delicious meals for family and friends. To help ensure the longevity and performance of your appliance, keep this guide handy. It will empower you with the best way to use and care for your product. Your satisfaction is our #1 goal. Remember to register your product online at www.kitchenaid.com, or by mail using the included Product Registration Card.



USA: 1.800.541.6390
Canada: 1.800.807.6777

KitchenAid.com
KitchenAid.ca

Table of Contents

TOASTER SAFETY	
Important Safeguards.....	4
Electrical Requirements.....	5
PARTS AND FEATURES.....	6
USING YOUR TOASTER	
Before First Use	7
Making Toast.....	8
SPECIAL TOASTING FUNCTIONS	
Toasting Bagels.....	9
CARING FOR YOUR TOASTER.....	9
TROUBLESHOOTING	10
WARRANTY	11

Proof of Purchase & Product Registration

Always keep a copy of the itemized sales receipt showing the date of purchase of your Toaster. Proof of purchase will assure you of in-warranty service. Before you use your Toaster, please fill out and mail your product registration card packed with the unit, or register online at www.kitchenaid.com.

This will enable us to contact you in the unlikely event of a product safety notification and assist us in complying with the provisions of the Consumer Product Safety Act. This card does not verify your warranty. Please complete the following for your personal records:

Model Number _____

Serial Number _____

Date Purchased _____

Store Name _____

Your safety and the safety of others are very important.

We have provided many important safety messages in this manual and on your appliance. Always read and obey all safety messages.



This is the safety alert symbol.

This symbol alerts you to potential hazards that can kill or hurt you and others.

All safety messages will follow the safety alert symbol and either the word “DANGER” or “WARNING.” These words mean:

 **DANGER**

You can be killed or seriously injured if you don't immediately follow instructions.

 **WARNING**

You can be killed or seriously injured if you don't follow instructions.

All safety messages will tell you what the potential hazard is, tell you how to reduce the chance of injury, and tell you what can happen if the instructions are not followed.

IMPORTANT SAFEGUARDS

When using electrical appliances, basic safety precautions should always be followed, including the following:

1. Read all instructions.
2. Do not touch hot surfaces. Use handles or knobs.
3. To protect against electrical shock, do not immerse cord, plugs, or toaster in water or other liquid.
4. Close supervision is necessary when any appliance is used by or near children.
5. Unplug toaster from outlet when not in use and before cleaning. Allow to cool before putting on or taking off parts.
6. Do not operate any appliance with a damaged cord or plug or after the appliance malfunctions or has been damaged in any manner. Return appliance to the nearest Authorized Service Facility for examination, repair or adjustment.
7. The use of accessory attachments not recommended by the appliance manufacturer may cause injuries.
8. Do not use outdoors.
9. Do not let cord hang over edge of table or counter, or touch hot surfaces.
10. Do not place on or near a hot gas or electric burner, or in a heated oven.
11. To disconnect, turn any control to “OFF,” then remove plug from outlet.
12. Do not use toaster for other than intended use.
13. Oversize foods, metal foil packages, or utensils must not be inserted in toaster as they may involve a risk of fire or electric shock.
14. A fire may occur if toaster is covered with or touching flammable material, including curtains, draperies, walls and the like, when in operation.
15. Do not attempt to dislodge food when toaster is plugged in.
16. This product is designed for household use only.

SAVE THESE INSTRUCTIONS

ELECTRICAL REQUIREMENTS

! WARNING



Electrical Shock Hazard

Plug into a grounded 3 prong outlet.

Do not remove ground prong.

Do not use an adapter.

Do not use an extension cord.

Failure to follow these instructions can result in death, fire, or electrical shock.

Volts: 120 Volts AC only.

Hertz: 60 Hz

NOTE: Your toaster has a 3-prong grounded plug. To reduce the risk of electrical shock, this plug will fit in an outlet only one way. If the plug does not fit in the outlet, contact a qualified electrician. Do not modify the plug in any way.

Do not use an extension cord. If the power supply cord is too short, have a qualified electrician or serviceman install an outlet near the appliance.

A short power supply cord (or detachable power supply cord) should be used to reduce the risk resulting from becoming entangled in or tripping over a longer cord.

Longer detachable power supply cords or extension cords are available and may be used if care is exercised in their use. If a longer detachable power supply cord or extension cord is used:

- The marked electrical rating of the cord set or extension cord should be at least as great as the electrical rating of the appliance.
- The cord should be arranged so that it will not drape over the countertop or tabletop where it can be pulled on by children or tripped over unintentionally.

If the appliance is of the grounded type, the extension cord should be a grounding-type 3-wire cord.

Parts and Features

4-Slice Model

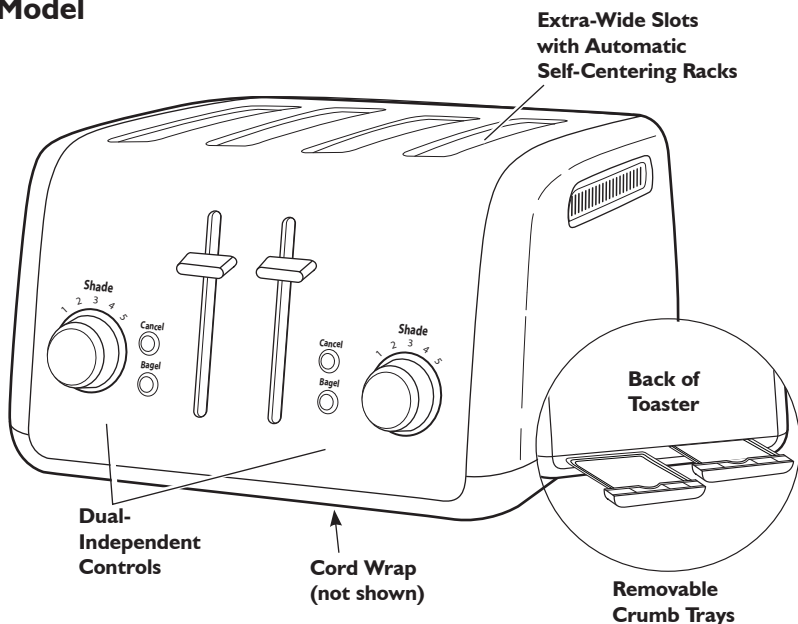

2-Slice Model

Extra-Wide Slots with Automatic Self-Centering Racks

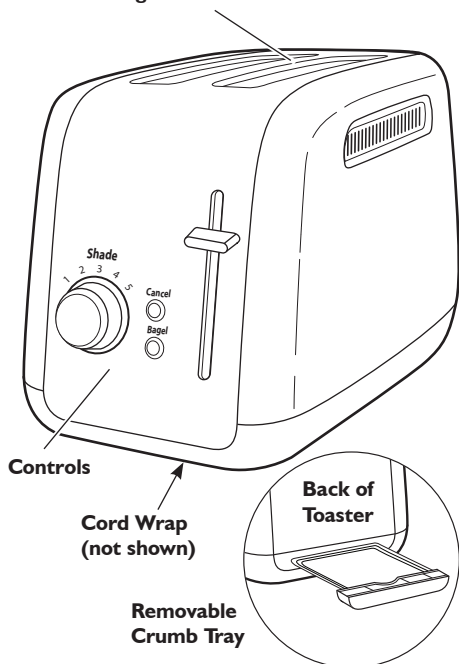

Extra-Wide Slots with Self-Centering Racks

Extra-wide slots allow you to easily toast bread, bagels, and English muffins up to $1\frac{1}{8}$ " (2.8 cm) thick. Self-centering racks help ensure even heating of thin or thick breads.

Controls

Easy-to-use controls with one-touch buttons allow you to quickly select the desired settings.

Cord Wrap

The cord wrap provides convenient storage of the cord when not in use.

Removable Crumb Tray

The removable crumb tray slides out for quick removal of crumbs. Hand-wash only.

Dual Independent Controls (4-slice models only)

Dual independent controls allow you to select different settings for each pair of slots.

Parts and Features

Shade Control Knob

Precisely sets the desired brownness level.

Bagel

Your Toaster features a special setting for bagels, ensuring optimal heat and time for the best results. The heating elements will adjust to nicely toast the inside of a cut bagel without burning the outside surface.

Cancel

Press the cancel button to stop a toasting cycle that is already in process.

High-Lift Lever

Press down to lower foods and start the toasting cycle. When toasting is complete, lever lifts food above toaster for easy removal.

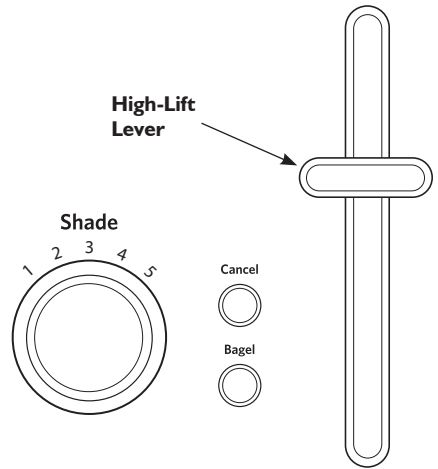

Using Your Toaster

Before First Use

Before using your Toaster, check the extra-wide slots and remove any packing or printed material that might have fallen inside during shipping or handling. Do not probe inside the Toaster with a metal object.

You may see light smoke the first time you use the Toaster. This is normal. The smoke is harmless and will soon disappear.

Using Your Toaster

Making Toast

1. Shorten cord, if necessary, by wrapping cord under the base. The toaster's feet are tall enough to allow the cord to exit from under any side of the toaster.

⚠ WARNING



Electrical Shock Hazard

Plug into a grounded 3 prong outlet.

Do not remove ground prong.

Do not use an adapter.

Do not use an extension cord.

Failure to follow these instructions can result in death, fire, or electrical shock.

2. Plug into a grounded 3-prong outlet.
3. Turn the Shade Control Knob to select the degree of brownness you want. Turn the Shade Control Knob to the right for darker toast or to the left for lighter.
NOTE: Different types of bread and their moisture levels may require different shade settings. For example, dry bread will brown more rapidly than moist bread and will require a lighter setting.

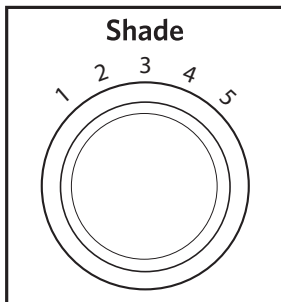

4. Insert bread or other food to be toasted in slot(s).

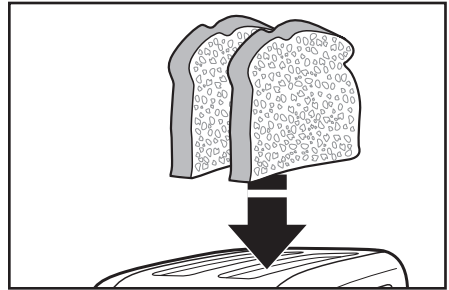

NOTE: For even toasting on 2-slot models, toast only one bread type and thickness at a time. If toasting two different types or thicknesses of bread with 4-slot models with Dual Independent Controls, be sure to toast only one bread type in each pair of slots.

If toasting bagels, be sure to press the Bagel button. See "Toasting Bagels".

5. Press down on Lift Lever to start the toasting cycle. The toast will rise automatically at the end of the cycle and the toaster will turn off.

TIP: For smaller items, lift up on the Lift Lever to raise toast above the top of the toaster.

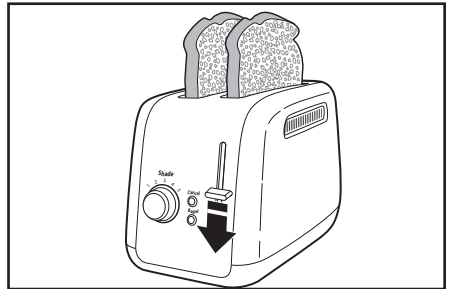

6. To cancel toasting at any time, press CANCEL. The toaster will raise the toast and turn off.

Cancel



Special Toasting Functions

Toasting Bagels

Your Toaster features a special setting for bagels, ensuring optimal heat and time for the best results. The heating elements will adjust to nicely toast the inside of a cut bagel without burning the outside surface.

1. Insert bagels with the cut side facing in, as shown.

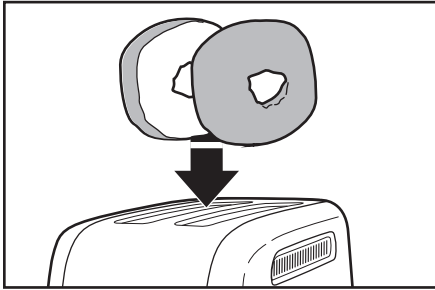

2. With the Shade Control Knob set to the desired level of brownness, press down on the Lift Lever to start the toasting cycle.
3. Press the Bagel button. The bagel(s) will rise automatically at the end of the cycle and the Toaster will turn off.

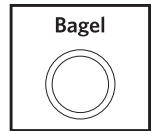

Caring for Your Toaster

1. Unplug the Toaster and let it cool before cleaning.
2. Grasp the center of the Crumb Tray then slide it out. Shake the crumbs into a waste container. It is recommended that the Crumb Tray be emptied after each use. Crumb Tray is hand-wash only.
IMPORTANT: The tray will be hot immediately following a toasting cycle.

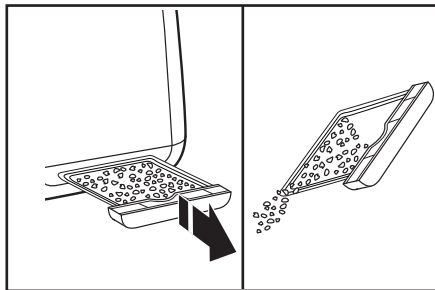

3. Wipe toaster with a soft, damp cotton cloth. Do not use paper towels, abrasive cleansers or liquid cleaning products. Do not immerse Toaster in water.
NOTE: If grease or oil splatters on the toaster, wipe splatters away immediately using a clean, damp cotton cloth.
4. Return Crumb Tray to Toaster. Press it in firmly until it clicks into position. Do not use the Toaster without the Crumb Tray in proper position.

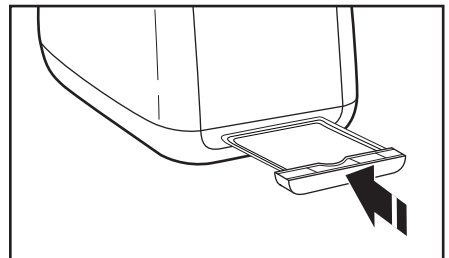

NOTE: KitchenAid does not recommend the use of a toaster cover.

⚠ WARNING



Electrical Shock Hazard

Plug into a grounded 3 prong outlet.

Do not remove ground prong.

Do not use an adapter.

Do not use an extension cord.

Failure to follow these instructions can result in death, fire, or electrical shock.

If your toaster should fail to operate, check the following:

1. Check that the Toaster is plugged into a grounded 3 prong electrical outlet. If it is, unplug the Toaster.
2. Plug in Toaster.

3. If the Toaster still does not work, check the household fuse or circuit breaker.

If the problem cannot be corrected:

See the KitchenAid Warranty and Service sections. Do not return the Toaster to the retailer; retailers do not provide service.

KitchenAid® Toaster Warranty for the 50 United States, the District of Columbia, Puerto Rico, and Canada

This warranty extends to the purchaser and any succeeding owner for Toasters operated in the 50 United States, the District of Columbia, Puerto Rico, and Canada.

Length of Warranty:	One Year Full Warranty from date of purchase.
KitchenAid Will Pay for Your Choice of:	Hassle-Free Replacement of your Toaster. See the next page for details on how to arrange for service, or call the Customer Satisfaction Center toll-free at 1-800-541-6390 . OR The replacement parts and repair labor costs to correct defects in materials and workmanship. Service must be provided by an Authorized KitchenAid Service Center.
KitchenAid Will Not Pay for:	<ul style="list-style-type: none">A. Repairs when Toaster is used in other than normal single family home use.B. Damage resulting from accident, alteration, misuse or abuse.C. Any shipping or handling costs to deliver your Toaster to an Authorized Service Center.D. Replacement parts or repair labor costs for Toasters operated outside the 50 United States, District of Columbia, Puerto Rico, and Canada.
DISCLAIMER OF IMPLIED WARRANTIES; LIMITATION OF REMEDIES IMPLIED WARRANTIES, INCLUDING TO THE EXTENT APPLICABLE WARRANTIES OF MERCHANTABILITY OR FITNESS FOR A PARTICULAR PURPOSE, ARE EXCLUDED TO THE EXTENT LEGALLY PERMISSIBLE. ANY IMPLIED WARRANTIES THAT MAY BE IMPOSED BY LAW ARE LIMITED TO ONE YEAR, OR THE SHORTEST PERIOD ALLOWED BY LAW. SOME STATES AND PROVINCES DO NOT ALLOW LIMITATIONS OR EXCLUSIONS ON HOW LONG AN IMPLIED WARRANTY OF MERCHANTABILITY OR FITNESS LASTS, SO THE ABOVE LIMITATIONS OR EXCLUSIONS MAY NOT APPLY TO YOU. IF THIS PRODUCT FAILS TO WORK AS WARRANTED, CUSTOMER'S SOLE AND EXCLUSIVE REMEDY SHALL BE REPAIR OR REPLACEMENT ACCORDING TO THE TERMS OF THIS LIMITED WARRANTY. KITCHENAID AND KITCHENAID CANADA DO NOT ASSUME ANY RESPONSIBILITY FOR INCIDENTAL OR CONSEQUENTIAL DAMAGES. This warranty gives you specific legal rights and you may also have other rights which vary from state to state or province to province.	



Hassle-Free Replacement Warranty – 50 United States, District of Columbia, and Puerto Rico

We're so confident the quality of our products meets the exacting standards of KitchenAid that, if your Toaster should fail within the first year of ownership, KitchenAid will arrange to deliver an identical or comparable replacement to your door free of charge and arrange to have your original Toaster returned to us. Your replacement unit will also be covered by our one year limited warranty. Please follow these instructions to receive this quality service.

If your Toaster should fail within the first year of ownership, simply call our toll-free

Customer Satisfaction Center at **1-800-541-6390** Monday through Saturday. Please have your original sales receipt available when you call. Proof of purchase will be required to initiate the claim. Give the consultant your complete shipping address. (No P.O. Box numbers, please.)

When you receive your replacement Toaster, use the carton and packing materials to pack up your original Toaster. In the carton, include your name and address on a sheet of paper along with a copy of the proof of purchase (register receipt, credit card slip, etc.).

Hassle-Free Replacement Warranty – Canada

We're so confident the quality of our products meets the exacting standards of the KitchenAid® brand that, if your Toaster should fail within the first year of ownership, KitchenAid Canada will replace your Toaster with an identical or comparable replacement. Your replacement unit will also be covered by our one year limited warranty. Please follow these instructions to receive this quality service.

If your Toaster should fail within the first year of ownership, take the Toaster or ship collect to an Authorized KitchenAid Service Centre. In the carton include your name and

complete shipping address along with a copy of the proof of purchase (register receipt, credit card slip, etc.). Your replacement Toaster will be returned prepaid and insured. If you are unable to obtain satisfactory service in this manner call our toll-free Customer Interaction Centre at **1-800-807-6777**.

Or write to us at:
Customer eXperience Centre
KitchenAid Canada
200 - 6750 Century Ave.
Mississauga, ON L5N 0B7

Arranging for Service after the Warranty Expires, or Ordering Accessories and Replacement Parts

In the United States and Puerto Rico:

For service information, , or to order accessories or replacement parts, call toll-free at **1-800-541-6390** or write to: Customer Satisfaction Center, KitchenAid Portable Appliances, P.O. Box 218, St. Joseph, MI 49085-0218

Outside the United States and Puerto Rico:

Consult your local KitchenAid dealer or the store where you purchased the Toaster for information on how to obtain service.

For service information in Canada:

Call toll-free **1-800-807-6777**.

Or write to:
Customer eXperience Centre
KitchenAid Canada
200 - 6750 Century Ave.
Mississauga, ON L5N 0B7